

## Epson SureColor F160 - A4



### Large Format Printers

[Printer Friendly Specs](#)

[Where to Buy](#)

[+ ENLARGE IMAGE](#)

### Overview

The Epson SureColor DS series was developed from the ground up to provide a superior solution for Dye Sublimation. Printers offer enhanced image quality with a lower running cost, all backed with a comprehensive factory warranty. The SC-F160 is a compact desktop model designed for low volume custom merchandise and décor production. It is particularly suited to photo imaging and merchandise work. It features an extremely compact design with simple operation and a convenient Continuous Ink Supply System (CISS). Prints are made on paper which can be transferred (sublimated) via a heat press onto material with a polyester base or polyester pre-treatment. Supplied as a package complete with ink and media, it can be driven by common graphic design and photo editing software.



The SureColor F160 uses inexpensive ink and A4 sheet-based media. Ink ships in bottles and is loaded into a small tank system while paper is loaded via a tray. It features the latest Epson print head and image processing technology that work together with the ink to enable high quality imaging with fine gradation and a wide gamut. It is easy to operate and prints quickly. Output can be sublimated onto polyester fabric and substrates that will accept a polyester coating and have moderate heat tolerance. The printer can be used with a variety of low-cost 3<sup>rd</sup> party heat presses.

#### FEATURES AT A GLANCE

**High Quality** – Epson PrecisionCore™ print head and UltraChrome™ Dye Sub ink for quality imaging at resolutions up to 600 x 1200dpi. Epson Precision Dot Technology enable prints with fine gradation, an expanded gamut, and low grain.

**Simple to Operate** – Tilt adjustable control panel with colour LCD and push-button operation, supplied with a driver that enables operation with common graphic and photo editing software.

**Easy to Install** – Extremely compact and desktop mountable; ships with over 1L of ink, and 300 pages of media; flexible operation using Wi-Fi/Ethernet/USB networking.

**High Productivity** – Incorporates a convenient tank system and a tray that holds up to 150 sheets, produces an A4 print in as little as 65s.

**Low Running Costs** – Ultra-low power consumption and is refilled using cost-effective bottled ink.

**Superior Reliability** – Supplied with a comprehensive single-source manufacturer warranty augmented with optional CoverPlus for up to 3 years' protection. <sup>1</sup>



#### OUTSTANDING QUALITY

The SureColor F160 incorporates an Epson PrecisionCore™ Thin Film print head with micro-fine nozzles that enable high-resolution imaging with pinpoint accuracy. Driven by Epson Precision Dot Technology, it facilitates precise and predictable colour with superior density, and enhanced tonal expression. The printer has a range of print modes to suit different quality levels and production speeds. It suits a wide range of applications including art and photography, hard and soft signage, short-run merchandise and décor, custom fabric and clothing.

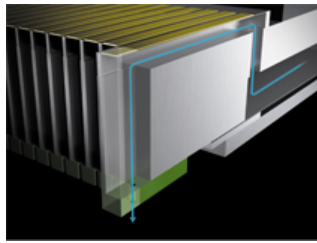

The SC-F160 uses a simple 4 colour imaging system. The advanced UltraChrome™ Dye Sub ink works in conjunction with the print head to produce superior output with a lower production cost and enhanced mechanical reliability. When sublimated, it produces a colour gamut that is equal or better than competing solutions that utilise more inks. It produces images with outstanding light and wash fastness, that are resistant to damage through abrasion and perspiration. When applied to polyester fabrics, material conforms to the latest Oeko-Tex Eco Passport® standard for safe use by adults, children and babies.<sup>2 3</sup>



#### FLEXIBLE WORKFLOW

Dye sublimation is designed to replace traditional screen printing. It is considerably simpler and less expensive for short-to-medium production runs with less labour, less materials, and less wastage. Digital imaging enables easier content creation and editing with more accurate and flexible output. Production is mess-free with faster job turnaround and repetition at the push of a button. The process suits fabric with a high polyester content and hard surface materials that will accept a polyester spray while withstanding a moderate level of heat and pressure. A wide range of products can be produced including fabric and photo merchandise, metal signs and phone covers, footwear ('thongs') and custom clothing, wall decorations and home décor.

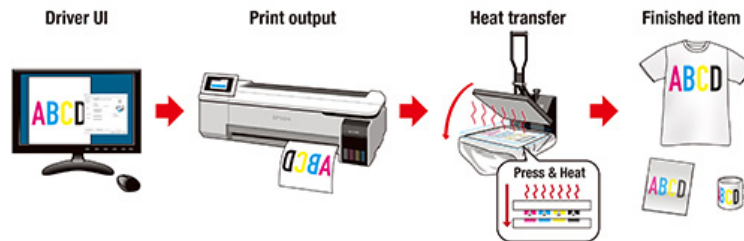

The Epson DS Fabric series has been designed for reliable and cost-effective operation. The SC-F160 features a Continuous Ink Supply System (CISS) that is refilled using inexpensive 140ml bottles. The engine features extremely low power consumption with sleep and standby modes to further reduce running costs. The printer ships complete with ink and media. It also ships with a driver that enables operation with standard graphic software.



The SureColor F160 can be used with a PC running Windows or Mac OS. It is extremely compact, light in weight and has a footprint of less than 0.15m<sup>2</sup> and supports both wired and wireless networking. It suits operation with a small flat-sheet or merchandise style heat press and features a convenient multi-page input tray as well as an extendable output tray.<sup>1</sup>



<sup>1</sup>Production will require a PC with moderate specifications and appropriate graphic software as well as a suitable sublimation device (heat press); customers are recommended to speak with their Authorised Epson Large Format Fabric Dealer for details and options. After-sales warranty and CoverPlus service are subject to a range of terms and conditions including operation within mechanical life ratings, the use of correct and genuine consumables; please see the specifications page and [warranty page](#) of this web site for further information.

<sup>2</sup>Dye Sub ink is relatively delicate prior to sublimation and needs to be handled with care. Please see the specs page for further information.

<sup>3</sup>ECO PASSPORT by OEKO-TEX® is an international standard for the textile industry system. It enables suppliers to demonstrate that products can be used in sustainable and safe textile production. For further information please see the [OEKO-TEX web site](#).

## Specification

### PRINT TECHNOLOGY

Print Head	PrecisionCore iJTFFP with VSDT
Nozzle Configuration	400 Black + 128 x CYM
Max Resolution	600 x 1200dpi
Min Drop Size	3.8pl

### INK SYSTEM

Family	Epson UltraChrome® Dye Sublimation
Type	Dye Sublimation
Colours	CYMK
Supply	120ml Black + 60ml x CYM CISS Tank System
Refills	140ml Bottles

### PERFORMANCE

Production	65s
Quality	152s

Figures represent print times for the indicated test image produced in A4 on Epson General Purpose DS Paper. The total throughput time for a particular job will depend on a number of factors including the PC specification, software selection, workflow, networking, file format / size, image size and print mode. Additional time will be required for sublimation.



### MEDIA SUPPORT

Media Type	A4 Epson General Purpose Dye Sub Paper
Minimum Margins	3mm top, bottom, left & right
Loading	150 page tray

### OPERATION

Control Panel	Tilt-adjustable with button control, 2.4" colour LCD display and integrated help
Interface	USB 2.0 & Ethernet 10Base-T/100Base-TX & Wi-Fi
Memory	132kb
Included Software	Windows Installer Package, Printer Driver, EpsonNet Setup, EpsonNet Print, EpsonNet Config, Firmware Updater, Software Updater, User Manual and Epson Device Admin on CD &/or via <a href="#">Web download</a>  Mac Installer Package, Printer Driver, EpsonNet Setup, EpsonNet Config, Firmware Updater, Software Updater and User Manual via ( <a href="#">Web download</a> )
System Requirements	Windows XP/7/8/10 (32/64bit) or Mac OS X 10.6.8 or later

### ENVIRONMENTAL

Physical (WxDxH)	375 x 347 x 187mm, 4.6kg (no ink or media)
Power Supply	AC 220~240V, 50/60Hz, 0.2A
Operational Temp	10°~35°C (15°~25°C recommended)
Operational Humidity	20 to 80% with no condensation (40-60% recommended)
Power Consumption	13W Operating, 4.1W Ready, 0.7W Sleep
Operating Noise	53dB
Operational Space (WxHxD)	375 x 503 x 187mm (recommended) Note: Additional space will be required for a heat press.

### SHIPPING INFO

Packaging (WxDxH)	Printer: 515 x 435 x 278mm, 7.2Kg Ink & Media Pack: 450 x 250 x 250mm, 5Kg
What's in the Box	Printer, 2 x Ink Bottle Set, 2 x Maintenance Tank, 3 x A4 Media Pack, Power Cord, Setup Guide, Software & User Manual CD.
Installation & Operation	A heat press will be required to enable production; details on models, features and pricing can be provided by your Epson Authorised Large Format Fabric Dealer.  A proportion of the ink and one of the maintenance tanks included with this printer will be used to 'prime' the machine during initial set-up.  Delivery, de-boxing and package removal is not typically included but can be provided at an additional charge for most locations. Reliable operation requires the printer be used on a regular basis and not left powered down for extended periods. The printer is not designed for mobile operation and may suffer leakage if shaken excessively. Dye sub ink is extremely stable once sublimated however care must be taken prior; unopened bottles should be stored in a cool environment away from sunlight and installed by the best before date printed on the package, ink should be consumed within one month of loading into tanks, opened bottles should be consumed within 6 months, and prints should be sublimated within a week of creation (1~2 days recommended).  This printer is designed to operate with specific consumables and be used for ad-hoc / low volume work. It does not suit applications which require continuous &/or high volume production. Please refer to the <a href="#">warranty section</a> for details on operational and mechanical life rating limitations.

### CONFIGURATION OPTIONS\*

SCF1601YR	Standard Model with 1Yr Warranty
-----------	----------------------------------

**ACCESSORIES & OPTIONS\***

1YWF160

1Yr CoverPlus On-Site Service Pack

**SERVICE & SUPPORT**

\*Printers are supplied with a comprehensive 1 year warranty that covers labour and all non-consumable parts (including Print Heads but excluding the tank system). It provides for free-on-site repair of equipment located in all metro areas (regional locations will attract an additional travelling charge). Cover can be extended up to a maximum of 3 years through purchase of optional CoverPlus packages either with the printer or up to 365 days subsequent to purchase (discounts apply for bundled purchase). CoverPlus provides additional cover for the tank system while extending the base parts and labour cover.

Support and Service is provided via authorised Epson authorised Large Format Fabric Dealers. If you have a problem with a SureColor Fabric printer, a related option or consumable please contact your dealer for initial problem evaluation. Should a printer require service this will be provided on-site free of charge within the period covered by your Warranty and any optional CoverPlus.

This printer is designed to be used with specific Epson media. While use of alternative media may be possible Epson is unable to provide any guidance or guarantees in regards reliability, performance, print or sublimation quality.

Important: Warranty and CoverPlus may be restricted or denied if the user does not perform maintenance & cleaning as outlined in the user guide and may be separately advised by Epson Australia or New Zealand, if equipment is modified, used outside of specification &/or with non-Epson consumables. Please refer to the [warranty section](#) of this web site for details and contact Epson or one of our Authorised Resellers if you have questions.

**Usage Conditions**

Epson products are designed to give highly reliable use and long life when used according to specifications. With any product or device used in situations where human life may be involved or at risk, Epson advises that you should take all necessary steps to ensure the suitability of your Epson product for inclusion in your system, and recommends that you include fail-safe procedures and redundancy support or backup equipment in your system, to maintain the maximum safety margin and optimum system reliability. Examples include but are not limited to – do not interfere with any electrical components within the device, do not use items supplied with the product for purposes other than as intended by Epson (ie mains cords, inks, CDs, plastic wrapping), do not make modifications to the product, take care with the use of 3rd party consumables, consult Epson if you have any questions or concerns.

**Consumables**

<b>INK CARTRIDGES</b>	<b>PRODUCT CODE</b>
<a href="#"><u>140ml UltraChrome T49N Dye Sub Black Ink Bottle</u></a>	C13T49N100
<a href="#"><u>140ml UltraChrome T49N Dye Sub Cyan Ink Bottle</u></a>	C13T49N200
<a href="#"><u>140ml UltraChrome T49N Dye Sub Magenta Ink Bottle</u></a>	C13T49N300
<a href="#"><u>140ml UltraChrome T49N Dye Sub Yellow Ink Bottle</u></a>	C13T49N400
<b>LARGE FORMAT PAPERS</b>	<b>PRODUCT CODE</b>
<a href="#"><u>A4 x 100 Sheets General Purpose Transfer Paper</u></a>	C13S400078
<b>LARGEFORMATOPTIONS</b>	<b>PRODUCT CODE</b>
<a href="#"><u>Replacement Maintenance Tank</u></a>	C13S210125
<a href="#"><u>SureColor-S/F/P Cleaning Sticks</u></a>	C13S090013
<a href="#"><u>Cleaning Wipes (Pack of 100)</u></a>	C13S090016

Epson is the registered trademark of Seiko Epson Corporation. Epson STYLUS, PerfectPicture, MicroPiezo, AcuPhoto Halftoning, QuickDry are the trademarks of Seiko Epson Corporation. All other names and company names used herein are for identification purpose only and may be the trademarks or registered trademarks of their respective owners. Epson disclaims any and all rights in those marks. All print samples shown herein are imulations. Specifications are subject to change without notice.